

✓

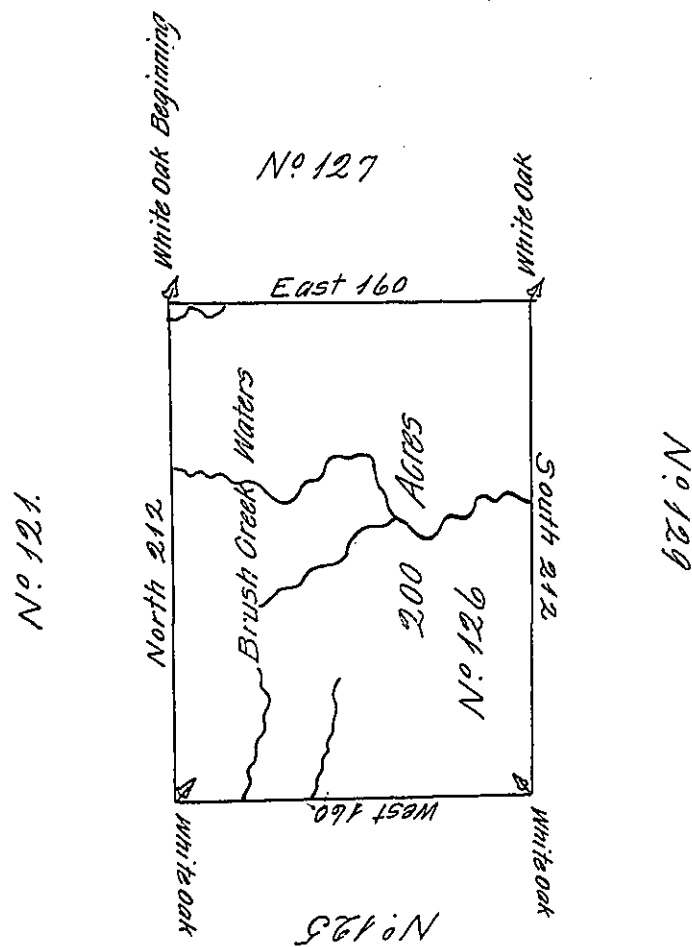

The above is a Draught of a Survey made in the month of July 1785 in Pursuance of Instructions from the Surveyor General Dated January 22^d 1785 Situate on the North Side of the Ohio River on the waters of Brush Creek in District No 2. Containing Two Hundred Acres with the Allowance of 6 P Cent.

Dan^l Leet D.S.

To John Lukas Esq^r SU^r G^r

IN TESTIMONY that the above is a copy of the original remaining on file in the Department of Internal Affairs of Pennsylvania, made conformably to an Act of Assembly approved the 16th day of February, 1833, I have hereunto set my Hand and caused the Seal of said Department to be affixed at Harrisburg, this fourteenth day of November 1905.

James P. Brown
 Secretary of Internal Affairs.